



ITEM	DESIGNATION	MERK	DESCRIPTION	ART. No.	UNIT WEIGHT
IP-S185	CENTERING BLADE	D1	PU P7100	911 320 066	47 g
IP-S186	CENTERING BLADE	D2	PU P7100	911 320 069	48 g
IP-S187	CENTERING BLADE	D1	TW11	911 120 243 911 120 212	47 g
IP-S188	CONNECTING BAR		P7100 L=184	911 118 117	76 g
IP-S189	ROD		4.8	911 317 208 911 618 002	76 g
IP-S190	PROJECTILE FEELER	D1		911 128 134	49 g
IP-S191	PROJECTILE FEELER	D2		911 128 136	48 g
IP-S192	PROJECTILE OPENER	D1		911 318 002	70 g
IP-S193	PROJECTILE OPENER	D2		911 318 003	68 g
IP-S194	COMPLATE	D1	TW11 PU P7100	912 520 003 911 820 021	106 g
IP-S195	COMPLATE	D2		912 520 041	106 g
IP-S196	BUSH	D1/D2	Nylon	912 120 221 911 220 221	3 g
IP-S197	PROJECTILE LIFTER	D1		911 117 146	194 g
IP-S198	PROJECTILE LIFTER	D2	TW11 PU	911 317 053	194 g
IP-S199	PROJECTILE LIFTER		P7200	917 750 495	210 g
IP-S200	PROJECTILE LIFTER UPPER PART	ES D1	5.8	911 317 055	43g
IP-S201	PROJECTILE LIFTER UPPER PART	MS D1	4.8	911 317 057	53 g
IP-S202	PROJECTILE LIFTER UPPER PART	D2	PU P7100	911 317 046 911 317 056	52 g
IP-S203	PROJECTILE GUIDE INSERT MS	D1	P7100	911 316 703	
IP-S204	FRONT GUIDE INSERT MS	D1	P7100	911 316 462	



IP-S205-S206



IP-S207



IP-S208



IP-S209



IP-S210



IP-S211



IP-S212



IP-S213-S214



IP-S215



IP-S216



IP-S217



IP-S218



IP-S219



IP-S220



IP-S221

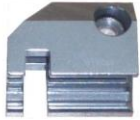

IP-S222



IP-S223



IP-S224



IP-S225



IP-S226

ITEM	DESIGNATION	MERK	DESCRIPTION	ART. No.	UNIT WEIGHT
IP-S205	PROJECTILE GUIDE BLOCK ES	D1	TW11 PU	911 116 162	159 g
IP-S206	PROJECTILE GUIDE BLOCK ES	D2	PU	911 116 302 911 316 299	159 g
IP-S207	PROJECTILE GUIDE BLOCK ES		P7100	911 316 454	51 g
IP-S208	PROJECTILE GUIDE BLOCK ES	D1	P7100	911 316 881	46 g
IP-S209	FRONT GUIDE INSERT ES	D1	PU	911 116 164 911 116 165 911 316 528	156 g
IP-S210	FRONT GUIDE INSERT ES	D2	P7100	911 316 462 911 316 703	101 g
IP-S211	FRONT GUIDE INSERT ES	D1	P7100	911 416 257	110 g
IP-S212	UPPER GUIDE RAIL MS	D1	P7100	911 311 119	110 g
IP-S213	UPPER GUIDE RAIL	D1	PU	911 316 172	555 g
IP-S214	UPPER GUIDE RAIL MS	D1	PU	911 316 572	560 g
IP-S215	UPPER GUIDE RAIL MS	D2	PU	911 316 468	600 g
IP-S216	UPPER GUIDE RAIL		P7100	911 416 062	560 g
IP-S217	UPPER GUIDE RAIL PLATE	D1	PU	911 116 150	37 g
IP-S218	UPPER GUIDE RAIL MS	D1	P7100	911 316 915 911 316 117 911 416 255 911 416 256 911 416 188	600 g
IP-S219	SI-GUIDE RAIL MS	D1	PU	911 316 153 911 316 268	235 g
IP-S220	SI-GUIDE RAIL MS		TW11	911 116 194	235 g
IP-S221	SI-GUIDE RAIL	D1/D12/D2	P7100 L=164	911 416 089	240 g
IP-S222	GUIDE BLOCK	D12	P7100	911 416 264	
IP-S223	PICKING GUIDE RAIL MS	D1	P7100	911 316 554	205 g
IP-S224	UPPER GUIDE RAIL		PS	930 215 109	545 g
IP-S225	WELFT-FEEDER GUIDE RAIL		PS	930 115 709	450 g

IP-S226	WELFT-FEEDER GUIDE RAIL		PS	930 215 685	1200 g
---------	-------------------------	--	----	-------------	--------



IP-S227-S228



IP-S229



IP-S230



IP-S231



IP-S232



IP-S233



IP-S234



IP-S235



IP-S236



IP-S237



IP-S238



IP-S239

ITEM	DESIGNATION	DESCRIPTION	ART. No.	UNIT WEIGHT
IP-S227	PROJECTILE GRIPPER	K2 2.2X3 2200	911 312 189	13.2 g
IP-S228	PROJECTILE GRIPPER	K2 2.2X3 1900	914 112 291	13.2g
IP-S229	FOOT	PU	911 359 109	64 g
IP-S230	CONVEYOR LINK	D1	911 131 160 911 331 712	27.5 g
IP-S231	CHAIN PIN		911 331 477 911 231 173	1 g
IP-S232	EXPELLOR FORK	METAL MATERIAL PU	911 330 034 911 130 133	49 g
IP-S233	EXPELLOR FORK	METAL MATERIAL P7100	911 330 011	49 g
IP-S234	EXPELLOR FORK	NYLON	911 330 069 911 130 069	19.5 g
IP-S235	EXPELLOR FORK	P7100 GREEN NYLON	911 830 004	21.5 g
IP-S236	SELECTOR	2 COLOR	911 840 149 911 840 064 911 840 044 911 840 072 911 840 055 911 840 146	183 g
IP-S237	SELECTOR	4 COLOR	911 841 234 911 841 071 911 841 016	258 g
IP-S238	SELECTOR	4 COLOR	911 841 016	320 g
IP-S239	OIL LEVER GLASS WITH O'RING	G 3/4"	911 866 010	27.5 g



IP-S240



IP-S241



IP-S242



IP-S243



IP-S244



IP-S245-S46



IP-S247



IP-S248



IP-S249



IP-S250



IP-S251



IP-S252



IP-S253

ITEM	DESIGNATION	DESCRIPTION	ART. No.	UNIT WEIGHT
IP -S240	ROLLER	TW11 PU PS $\Phi 25 \times 15 \times 11.8$	911 100 218 911 619 034	27 g
IP -S241	T SHAFT	TW11 PU PS		41 g
IP -S242	SLIDING BOLT FOR PROJECTILE FEEDER	P7100 9X2.3/11.2X9.3	911 319 876	2.4 g
IP -S243	AXLE BUSH	PU	911 109 293	18 g
IP -S244	PROJECTILE FEEDER LINK	P7100	911 819 384	44 g
IP -S245	GUIDE TEETH ALIGNMENT BAR	D2	911 600 133	
IP -S246	GUIDE TEETH ALIGNMENT BAR	$\Phi 2$ L=300 mm		290 g
IP -S247	FRONT PICKING BLOCK	PU ES D1	911 116 177	1200 g
IP -S248	FRONT PICKING BLOCK	PU MS D1	911 116 179	1020 g
IP -S249	OSCILATION DIE		911 100 456	57 g
IP -S250	FINISH DIE		911 100 457	57 g
IP -S251	ECCENTRIC ROD	L=177		70 g
IP -S252	ECCENTRIC ROD	L=178		70 g
IP -S253	ECCENTRIC ROD	L=187		75 g



ITEM	DESIGNATION	DESCRIPTION	ART. No.	UNIT WEIGHT
IP-S254	PROJECTILE GREEPER P7200	K3 2.2X3.9 2500 g WITH GROOVE	716 684 000	17 g
IP-S255	PROJECTILE GREEPER P7200	K3 2.2X3.9 2200 g WITH GROOVE	716 798 000	17 g
IP-S256	PROJECTILE GREEPER P7200	K3 2.2X3.9 2200 g KNURLED	716 718 000	17 g
IP-S257	PROJECTILE GREEPER P7200	K3 2.2X3.9 2500 g KNURLED	716 713 000	17 g
IP-S258	PROJECTILE GREEPER P7200	K3 2.2X3.9 2500 g SMOOTH & KNURLED	714 381 000	17 g
IP-S259	PROJECTILE GREEPER P7200	K3 2.2X3.9 1900 g SMOOTH	716 340 000	17 g
IP-S260	PROJECTILE GREEPER P7200	K3 2.2X3.9 2200 g SMOOTH	713 693 000	17 g
IP-S261	PROJECTILE GREEPER P7200	K3 2.2X3.9 2200 g SMOOTH	716 339 000	17 g
IP-S262	PROJECTILE GREEPER P7200	K3 2.2X3.9 2200 g SMOOTH & LYNON	713 469 000	17 g
IP-S263	PROJECTILE GREEPER P7200	K3 2.2X3.9 2500 g SMOOTH & LYNON	717 534 000	17 g
IP-S264	CLAMP LINNING	K3 P7200 2.2X3.9 mm	911 312 042 911 612 021	0.1 g
IP-S265	DAMPING INSERT	K3 P7200	717 494 000	1 g
IP-S266	PROJECTILE BODY	K3 P7200 CARBON FIBRE 2 HOLE	717 994 000	11 g
IP-S267	PROJECTILE BODY	K3 P7200 CARBON FIBRE 4 HOLE	715 796 000	11 g
IP-S268	PROJECTILE BOLT	K3 Φ 3X7.95 CARBON FIBRE	716 345 000	0.2 g
IP-S269	PROJECTILE BOLT	K3 Φ 7X7.95 CARBON FIBRE	716 344 000	1 g
IP-S270	WEFT FEEDER	P7200 1200 g SMOOTH	715 895 000	10 g
IP-S271		P7200 1200 g KNURLED	715 900 000	10 g
IP-S272		P7200 1500 g SMOOTH	715 896 000	10 g
IP-S273		P7200 1200 g SMOOTH + KNURLED	715 902 000	10 g
IP-S274		P7200 1500 g SMOOTH + KNURLED	713 234 000 714 428 000 714 928 000	10 g
IP-S275	WEFT FEEDER BAR	P7200 L=230	722 539 000 917 750 295 917 750 362	24 g

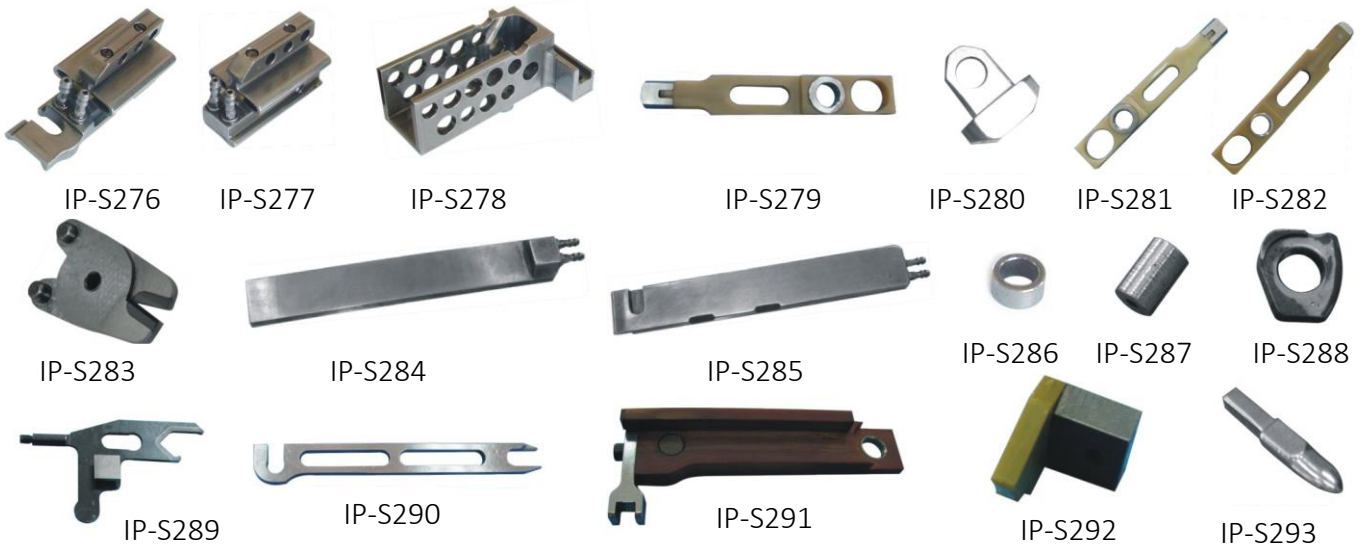

ITEM	DESIGNATION	DESCRIPTION	ART. No.	UNIT WEIGHT
IP-S276	FRONT BRAKE SADDLE	P7200	917 750 323	113 g
IP-S277	REAR BRAK SADDLE	P7200	917 750 324 917 750 657	137 g
IP-S278	HOLDER OF PROJECTILE BRAKE	P7200	917 750 395	258 g
IP-S279	PROJECTILE RETURNER	P7200	917 750 672	40 g
IP-S280	PROJECTILE RETURNER INSERT	P7200	716 970 000	3 g
IP-S281	PROJECTILE RETURNER	P7200		38 g
IP-S282	PROJECTILE RETURNER	P7200		34 g
IP-S283	SCISSORS	P7200 D1	956 802 034	14 g
IP-S284	BRAKE PLATE	P7200 L=164	714 213 000	160 g
IP-S285	BRAKE PLATE	P7200 L=165	714 208 000	160 g
IP-S286	PICKING LEVER BUSH	P7200	710 736 000	2.5 g
IP-S287	PICKING LEVER BOLT	P7200	710 739 000	0.5 g
IP-S288	THRUST SHOE	P7200	711 787 000	1.7 g
IP-S289	CENTERING BLADE	P7200	917 750 123	20 g
IP-S290	WEFT TRANSMITLER OPENER	P7200	719 007 000	53 g
IP-S291	WEFT FEEDER SLIDING PIECE	P7200	917 750 499	61 g
IP-S292	CONTROL CURVE	P7200	722 556 000 912 370 078	43 g
IP-S293	PROJECTILE OPENER	P7200	722 343 000	5 g



ITEM	DESIGNATION	DESCRIPTION	ART. No.	UNIT WEIGHT
IP-S294	PROJECTILE OPENER	PS	930 817 018	148 g
IP-S295	PROJECTILE GUIDE INSERT	PS	930 215 678	50 g
IP-S296	THREAD BLOCK	PS	930 827 011	199 g
IP-S297	GRIPPER	PS	930 129 946	19 g
IP-S298	CENTERING BLADE	PS	930 819 027	47 g
IP-S299	CENTERING BLADE	PS	930 819 027	53 g
IP-S300	PISTON	PS	930 315 469	55 g
IP-S301	EXCHANGE GROUP	PS	822 700 401	80 g
IP-S302	RECEIVING BOX OUTER PART	PS	930 124 648	208 g
IP-S303	OPENER SUPPORT	PS		60 g
IP-S304	CAM CLAM BOARD	PS	930 119 669	148 g
IP-S305	CHAIN LINK	PS	930 831 052	15 g
IP-S306	PROJECTILE FEEDER GRIPPER	PS	930 119 418 930 119 419	7 g
IP-S307	SCREW SETS	PS SCREW	930 119 852	4g
		PS BUSH	930 119 851	
IP-S308	PROJECTILE FEEDER	PS	930 119 408	11 g
IP-S309	PICKING LEVER	PS Φ 40	930 822 026	660 g
IP-S310	PROJECTILE RETURNER	PS	930 229 036	118 g
IP-S311	FEEDER OPENER	PS	930 129 474	3.5 g
IP-S312	PROJECTILE LIFTER	PS	930 817 022	328 g



IP-S313



IP-S314



IP-S315



IP-S316



IP-S317



IP-S318



IP-S319



IP-S320



IP-S321



IP-S322



IP-S327



IP-S328



IP-S323



IP-S324



IP-S325



IP-S326

ITEM	DESIGNATION	DESCRIPTION	ART. No.
IP-S313	Φ=10	BRAKE LEVER Φ=10	911 814 226
IP-S314	Φ=10	TANGLE LEVER Φ=10	911 814 227
IP-S315	KS Φ=10	BRAKE LEVER Φ=10	911 814 225
IP-S316	WS Φ=10	TANGLE LEVER WS Φ=10	911 814 233
IP-S317		SCREW	911 005 137
IP-S318		SLISSOR HOLEDER	912 520 076
IP-S319		SHAFT	911 005 353
IP-S320			911 310 113
IP-S321	Z=13	PINION SHAFT Z=13	912 510 101
IP-S322	Z=10	PINION SHAFT Z=10	911 110 341
IP-S323			911 309 014
IP-S324		CLAMPING LOOP Φ35	911 839 003
IP-S325		BEND BAR	740 939 000
IP-S326			911 307 007
IP-S327		CUTTING DEVICE WITH SCISSORS DRIVEN SU	911 838 121 911 838 089
IP-S328		CUTTING DEVICE WITH SCISSORS DRIVEN SU	911 838 123 911 838 091



IP-S329



IP-S330



IP-S331



IP-S332

IP-S333



IP-S334



IP-S335



IP-S336



IP-S337



IP-S338



IP-S342



IP-S339



IP-S340



IP-S341



IP-S343

ITEM	DESIGNATION	DESCRIPTION	ART. No.
IP-S329		KSA -SHAFT	912 505 023
IP-S330		SCREW	911 005 224
IP-S331			911 128 368
IP-S332		HANDLE	911 325 037
IP-S333		CLAMPING NUT	911 325 035
IP-S334		SLIDE 6 HOLES	911 825 018
IP-S335	8X5	BAR 8X5	911 129 179
IP-S336			923 000 042
IP-S337		ROD: M5X105.5 SW8	911 330 078
IP-S338		SPRING	
IP-S339		BRAKE LINING	911 304 368
IP-S340	P7100	P7100 TEMPLE RING	
IP-S341	P7100	P7100 TEMPLE RING WITH 11 RING	
IP-S342	FA	TEMPLE STAY COMPLETE FA	
IP-S343	SU	TEMPLE STAY COMPLETE SU	



IP-S344



IP-S345



IP-S346



IP-S347



IP-S348



IP-S349



IP-S350



IP-S351



IP-S352



IP-S353



IP-S354



IP-S355



IP-S356

ITEM	DESIGNATION	DESCRIPTION	ART. No.
IP-S344		ROLLER LEVER COMPLETE SINGLE	911 805 012
IP-S345		SWITCH WHEEL HUB 25°	911 305 262
IP-S346		ROLLER LEVER FOR DAUBLE STEOKE	911 105 336
IP-S347		SWITCH WHEEL HUB 28°	911 305 599
IP-S348	PU D1	SPLINED BUSH PU D1	911 110 144
IP-S349	P7100	BEARING BUSH P7100	911 122 295
IP-S350			911 205 288
IP-S351		STUD	911 010 239
IP-S352			911 115 386
IP-S353		STUD	911 110 353
IP-S354			912 506 231
IP-S355			912 505 138
IP-S356		WARP BEAM BEARING SU/FA	911 864 022



IP-S357



IP-S358



IP-S359



IP-S360



IP-S361-S362



IP-S363-S373



IP-S374



IP-S375



IP-S376



IP-S377



IP-S378



IP-S379

ITEM	DESIGNATION	DESCRIPTION	ART. No.
IP-S357		THREADA PIN M12X0.5 mm	911 827 016
IP-S358			911 819 048
IP-S359		BEARING	924 551 000
IP-S360	2:60	RATCHEDT 2:60	911 310 243
IP-S361	Z=14	CHANGE GEAR Z=14	911 110 423
IP-S362	Z=15	CHANGE GEAR Z=15	911 110 401
IP-S363	Z=23	CHANGE GEAR Z=23	911 110 424
IP-S364	Z=26	CHANGE GEAR Z=26	911 110 412
IP-S365	Z=34	CHANGE GEAR Z=34	911 110 413
IP-S366	Z=37	CHANGE GEAR Z=37	911 110 422
IP-S367	Z=38	CHANGE GEAR Z=38	911 110 414
IP-S368	Z=42	CHANGE GEAR Z=42	911 110 415
IP-S369	Z=46	CHANGE GEAR Z=46	911 110 416
IP-S370	Z=49	CHANGE GEAR Z=49	911 110 417
IP-S371	Z=50	CHANGE GEAR Z=50	911 110 418
IP-S372	Z=51	CHANGE GEAR Z=51	911 110 419
IP-S373	Z=52	CHANGE GEAR Z=52	911 110 420
IP-S374		TENNEX PIN 5X107.5	921 877 121
IP-S375		SPECIAL SCREW M5X30	911 323 813
IP-S376		SPECIAL SCREW M5X14	911 219 220
IP-S377		WASHER	911 109 253
IP-S378		SPECIAL RIVET	911 290 163
IP-S379		DOLLA 25/35X0.8	911 109 292



IP-S380



IP-S381



IP-S382



IP-S383



IP-S384



IP-S385



IP-S386



IP-S387



IP-S388



IP-S389



IP-S390



IP-S391



IP-S392



IP-S393



IP-S394



IP-S395



IP-S396



IP-S397



IP-S398

ITEM	DESIGNATION	DESCRIPTION	ART. No.
IP-S380	Z=48	GLOBOID WHEEL Z=48	912 511 039
IP-S381			911 105 198
IP-S382	P7100 8:55	GLOBOID WORM WHEEL P7100 8:55	912 510 114
IP-S383	Z=23	INTER MEDIATE GEAR WHEEL Z=23	912 510 129
IP-S384	28°		911 305 285
IP-S385	Z=28	CHAIN WHEEL Z=28	711 061 000
IP-S386	Z=21	GEAR WHEEL Z=21	911 105 313
IP-S387	Z=16	TENSION WHEEL Z=16	912 549 006
IP-S388	Z=93 TW11	BRAKE RING Z=93	911 105 348
IP-S389	25°		911 305 295
IP-S390			912 522 153
IP-S391			911 316 447
IP-S392		CLUTCH LINNIG	911 105 455
IP-S393		CAM DISC 40°	911 805 042
IP-S394		CAM DISC FOR SIMPLE STROKE	911 805 041
IP-S395		BEARING	924 925 200
IP-S396		BEARING	927 410 660
IP-S397		COVER PLATE	911 303 281
IP-S398		GLOBOID WHEEL Z=49	911 110 221



IP-S399-S400



IP-S401



IP-S402



IP-S403



IP-S404



IP-S405



IP-S406



IP-S407



IP-S408



IP-S409



IP-S410



IP-S411



IP-S412



IP-S413



IP-S414

ITEM	DESIGNATION	DESCRIPTION	ART. No.
IP-S399	1:60	WORM GEAR 1:60	912 510 115
IP-S400	8:55	WORM GEAR 8:55	912 510 118
IP-S401			912 508 047
IP-S402	P7100	SPRING CONVEYOR	911 331 217
IP-S403		BEARING SYNTETIC $\Phi=34$	912 559 211
IP-S404	P7100	CONVEYOR COVER P7100	911 331 548
IP-S405	PU	CONVEYOR COVER P7100 D2 D12	911 131 681
IP-S406			912 514 239
IP-S407			911 309 626
IP-S408			911 109 406
IP-S409		STEEL HEALDS 331 mm J TYPE WITH EYE 6.5X1.8	
IP-S410		SPRING	911 228 127
IP-S411		SPRING	911 120 223
IP-S412		SPRING	911 114 537
IP-S413		SPRING	911 214 133
IP-S414			911 130 161



IP-S415



IP-S416



IP-S417



IP-S418



IP-S419



IP-S420



IP-S421



IP-S422



IP-S423



IP-S424



IP-S425



IP-S426



IP-S427



IP-S428



IP-S429

IP-S430

ITEM	DESIGNATION	DESCRIPTION	ART. No.
IP-S415		SET SLIDING HUT	912 310 095
IP-S416		CONTACT BAR GUIDE T-26mm	911 107 269
IP-S417			911 149 235
IP-S418		EYE LET PIECE WITHEYE LET $\Phi=7$ mm	911 814 018
IP-S419		GUIDE HOOK	911 106 749
IP-S420	P7100	ANGLE DISK P7100	911 303 768
IP-S421		PERLON BRUSH 44X24.5/90/0.4	911 331 599
IP-S422	D1 D2	GREASE FELT HOUSING D1 D2	911 316 771 911 816 006
IP-S423		DUMPING BUSH	911 304 325
IP-S424			921 009 976
IP-S425			921 010 662
IP-S426			921 875 708
IP-S427			911 330 078
IP-S428	D1	RATCHED D1	911 330 023
IP-S429	P7100	WEFT TENSION LEVER D1 P7100	930 814 001
IP-S430	PU	WEFT TENSION LEVER PU D1	911 814 173



IP-S431



IP-S433



IP-S435



IP-S432



IP-S434



IP-S436



IP-S437



IP-S438



IP-S439



IP-S440

ITEM	DESIGNATION	DESCRIPTION	ART. No.
IP-S431	D1	SIX GEAR COMBINATION PILOT SHUTTLE GEAR D1	911 323 622 911 323 272
IP-S432	D1	FUOR GEAR COMBINATION PILOT SHUTTLE GEAR D1	911 320 623
IP-S433	D2	SIX GEAR COMBINATION PILOT SHUTTLE GEAR D2	911 323 261
IP-S434	D2	FUOR GEAR COMBINATION PILOT SHUTTLE GEAR D2	911 323 388
IP-S435		SIX GEAR COMBINATION PILOT SHUTTLE GEAR HOLDER	911 123 307
IP-S436		FUOR GEAR COMBINATION PILOT SHUTTLE GEAR HOLDER	911 123 308
IP-S437		SU PILOT SHUTTLER GEAR	911 416 081
IP-S438	PU D1	PILOT SHUTTLE GEAR PU D1	911 123 337
IP-S439	PU D2	PILOT SHUTTLE GEAR PU D2	911 123 732 911 323 125
IP-S440		COMBINATION PILOT SHUTTLE GEAR HOLDER SCREW	911 323 216

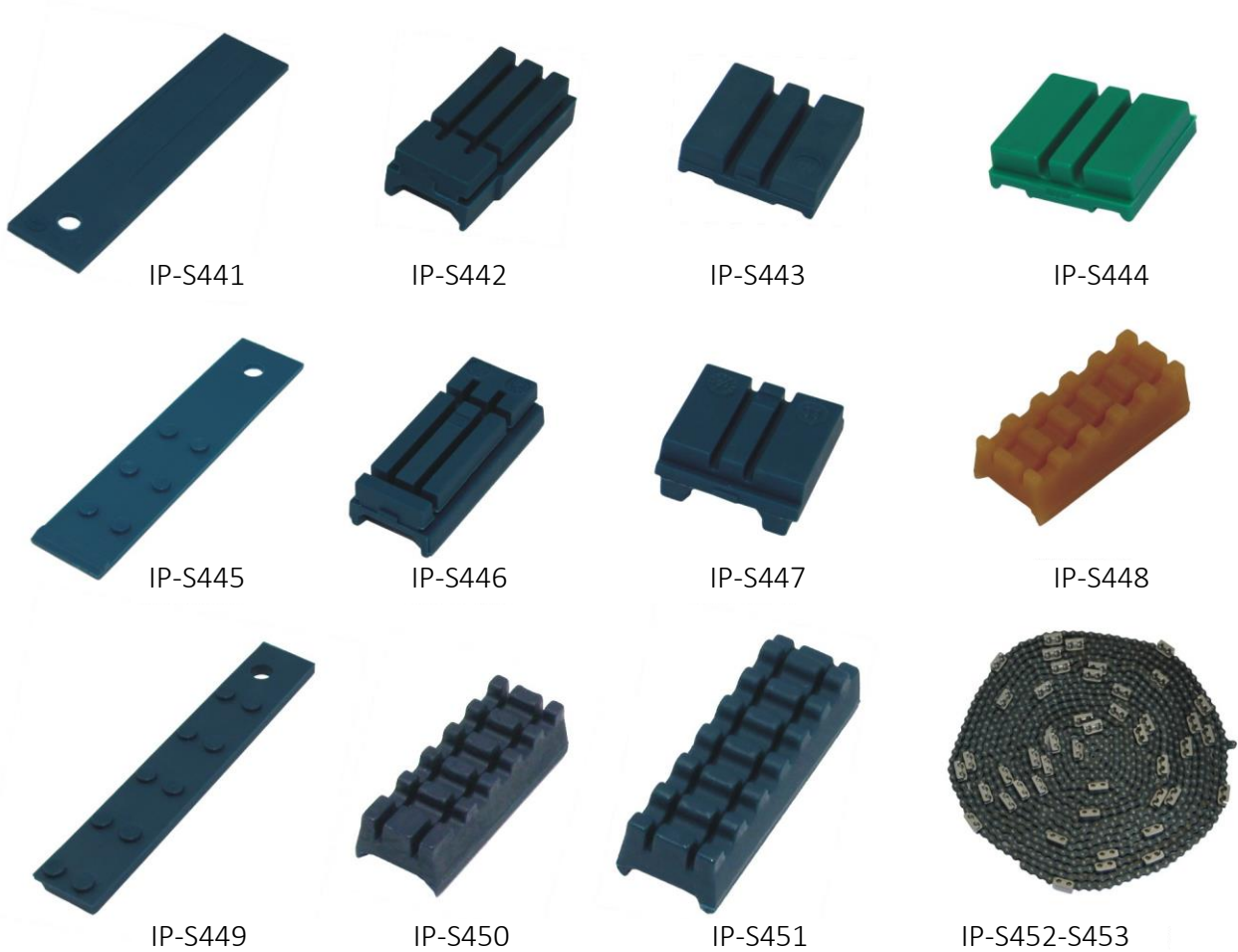

ITEM	DESIGNATION	DESCRIPTION	ART. No.
IP-S441	TW11	LOWER BRAKE LINING TW11	911 127 172
IP-S442	TW11	FRONT BRAKE LINING TW11	911 127 175
IP-S443	TW11	UPPER REAR BRAKE LINING TW11	911 127 170
IP-S444	TW11	REAR BRAKE LINING TW11 WITH GROOVE	911 327 059
IP-S445	PU	LOWER BRAKE LINING PU	911 327 003
IP-S446	PU	UPPER FRONT BRAKE LINING PU	911 327 353
IP-S447	PU	UPPER REAR BRAKE LINING PU	911 357 271
IP-S448	P7100 8 GRANULE	BACK BRAKE LINING P7100 8 GRANULE	911 327 718
IP-S449	P7100 10 GRANULE	LOWER BRAKE LINING P7100 10 GRANULE	911 327 675
IP-S450	P7100 10 GRANULE	UPPER FRONT BRAKE LINING P7100 10 GRANULE	911 327 676
IP-S451	P7100 10 GRANULE	UPPER REAR BRAKE LINING P7100 10 GRANULE	911 327 677
IP-S452	153"	CONVEYOR CHAIN 153"	912 531 015

IP-S453	213"	CONVEYOR CHAIN 213"	912 531 021
---------	------	---------------------	-------------



IP-S454



IP-S455



IP-S456



IP-S457



IP-S458



IP-S459



IP-S460



IP-S461



IP-S462



IP-S463



IP-S464



IP-S465



IP-S466



IP-S467

ITEM	DESIGNATION	DESCRIPTION	ART. No.
IP-S454		MIXING WEFT BIPOLAR SOLENOID	845 021 000 845 021 001 927 009 861
IP-S455	SMP	PFR SENSOR D2 , P7100	845 029 000 845 031 000
IP-S456	FT	FLIGHT TRIGGER FT	911 321 058
IP-S457	FT	FLIGHT TRIGGER FT	911 329 062 911 321 011
IP-S458	WIS	ANGLE SENSOR WIS	911 302 508
IP-S459	WIS	ANGLE SENSOR	911 328 022 911 802 333 911 310 005
IP-S460	SFW	SENSOR HEAD	911 321 062
IP-S461	SFW	WEFT SENSOR SFW	911 328 097 911 325 019 911 328 098
IP-S462	SFW	SENSING HEAD	911 321 038 911 321 066
IP-S463	TSN	GRPPER SHUTTLE	911 328 097 911 328 069 911 325 501
IP-S464	TSN	GRIPPER SHUTTLE SENSOR	911 328 097
IP-S465	SU	FAS-PARKING S SENSOR SU	927 009 861 845 021 000 845 021 001
IP-S466	KAS	ELECTRONIC MOTOR LET OFF SENSOR KAS	930 202 669
IP-S467	FA	FAS-PARKING S SENSOR FA	911 180 593